



**MANUAL OF USE
INSTALLATION & OPERATION**

OUTDOOR 4D FIREPLACE

CONTENTS

1. INTRODUCTION.
2. NOTE BEFORE INSTALLATION
3. ASSAMBLY INSTRUCTIONS
4. FUEL CHOICE
5. PLACEMENT FROM NON COMBUSTIBLE MATERIALS
6. POSITIONING OF THE OUTDOOR FIREPLACE
7. STARTUP AND OPERATION
8. CLEANING AND MAINTENANCE
9. WARRANTY

Thank you for your trust and for choosing A.Caminetti 4D outdoor fireplace !

We can be confident that our commitment to designing and manufacturing fireplaces will be matched by your satisfaction in making this excellent choice. Please read all the sections in this Manual carefully before starting any installation work and use. Please contact our technical-support department if you have any queries or doubts. For any further information go to:

www.acaminetti-factory.com.

A.Caminetti is a renowned and appreciated heating appliance manufacturer, on European market. Our products are made in compliance with stringent standards. Each of the fireplace fireboxes we have manufactured undergoes internal quality inspection, during which it is assessed in rigorous safety tests. The prime-quality materials we use in the production ensures that the final user will benefit from a functional and reliable heating unit. This manual provides all the necessary information for the correct connection, operation and maintenance of an outdoor fireplace.

INTRODUCTION

This manual provides all the necessary information for the correct connection, operation and maintenance of the firebox.



Please make sure that the OUTDOOR FIREPLACE is operated in the correct way: use suitable wood, and clean regularly, to be rewarded with many wonderful and warm autumns and winters.

- **This product is for OUTDOOR USE ONLY, and should NOT be used in a building, garage, or any other enclosed area.**
- **Do NOT use this outdoor fireplace for indoor heating. Toxic carbon monoxide fumes can be very dangerous.**
- **The 4D outdoor fire is NOT allowed to be operated by children.**
- **Do not use the outdoor fireplace without reading the entire “Manual”**

NOTE BEFORE INSTALLATION!!!



To prevent the risk of fire, the heater must be installed in compliance with the rules and regulations of this User Manual.

- Do not use the outdoor fire without reading the entire "Manual"
- Use dry hardwood with a Humidity of up to 20 %, It will burn hotter, more completely and create less smoke.
- Do NOT burn charcoal briquets, lump charcoal, driftwood, rubbish, leaves, paper, cardboard, plywood, painted or stained or pressure treated wood. Avoid using softwoods such as pine or cedar that can throw sparks out.
- Do NOT use the outdoor fire until it is completely assembled.
- Do NOT store or use any flammable liquids or vapours in the vicinity of the outdoor fireplace.
- Check the chimney flue at least once a year.
- Remove ash from the ash trap regularly
- Do not overheat the firebox: maximum load must not exceed 1/3 of the combustion-chamber volume
- Clean the glass with agents intended for such use, keeping in mind not to apply them directly onto the glass, but on a cloth.
- Do NOT use the outdoor fireplace near any Motor vehicle or recreational vehicle.
- Do NOT use in an explosive atmosphere. Keep the area clear from combustible materials.
- Do NOT use the A.caminetti outdoor fire under any overhead or near any unprotected combustible constructions avoid using near or under overhanging trees or shrubs.
- Always use the outdoor fireplace on a hard, level non-combustible surface, Asphalt may not be acceptable for this. Do NOT use on Wooden decking.
- Do NOT use petrol, kerosene, diesel, lighter fluid or alcohol to light or relight fires.
- Keep all electrical cords, cables away from the outdoor fireplace.
- All Surfaces of the outdoor fire are hot when in operation. To avoid burns, do NOT touch outdoor fire until it has completely cooled unless you are wearing protective gear (heat-resistant gloves, BBQ mittens etc.) Never touch ashes or logs to see if they are hot.!
- Do Not leave a lit outdoor fire unattended, especially around children and pets
- Do NOT attempt to move the outdoor fireplace until all ashes and coals are completely extinguished.
- Do Not remove ashes or logs until they are completely and fully extinguished.
- Use heat-resistant gloves or tool when opening and closing door.



ASSEMBLY INSTRUCTION

The heater is delivered in a ready-to-be-installed state. Remove the packaging and check the appliance for completeness according to this Operation Manual. You should also ensure that the following are operational.

POSITIONING THE OUTDOOR FIREPLACE AT A SAFE DISTANCE

The fireplace should be positioned on a non-flammable floor - Always use the outdoor fireplace on a hard, level non-combustible surface, Asphalt may not be acceptable for this. Do NOT use on Wooden decking.

PLACEMENT FROM NON COMBUSTIBLE MATERIALS

The recommend minimum distance from outdoor fireplace to combustible materials is 60 cm. Note that some furniture is more easily affected by heat and may need to be moved to greater distance. This is your responsibility!

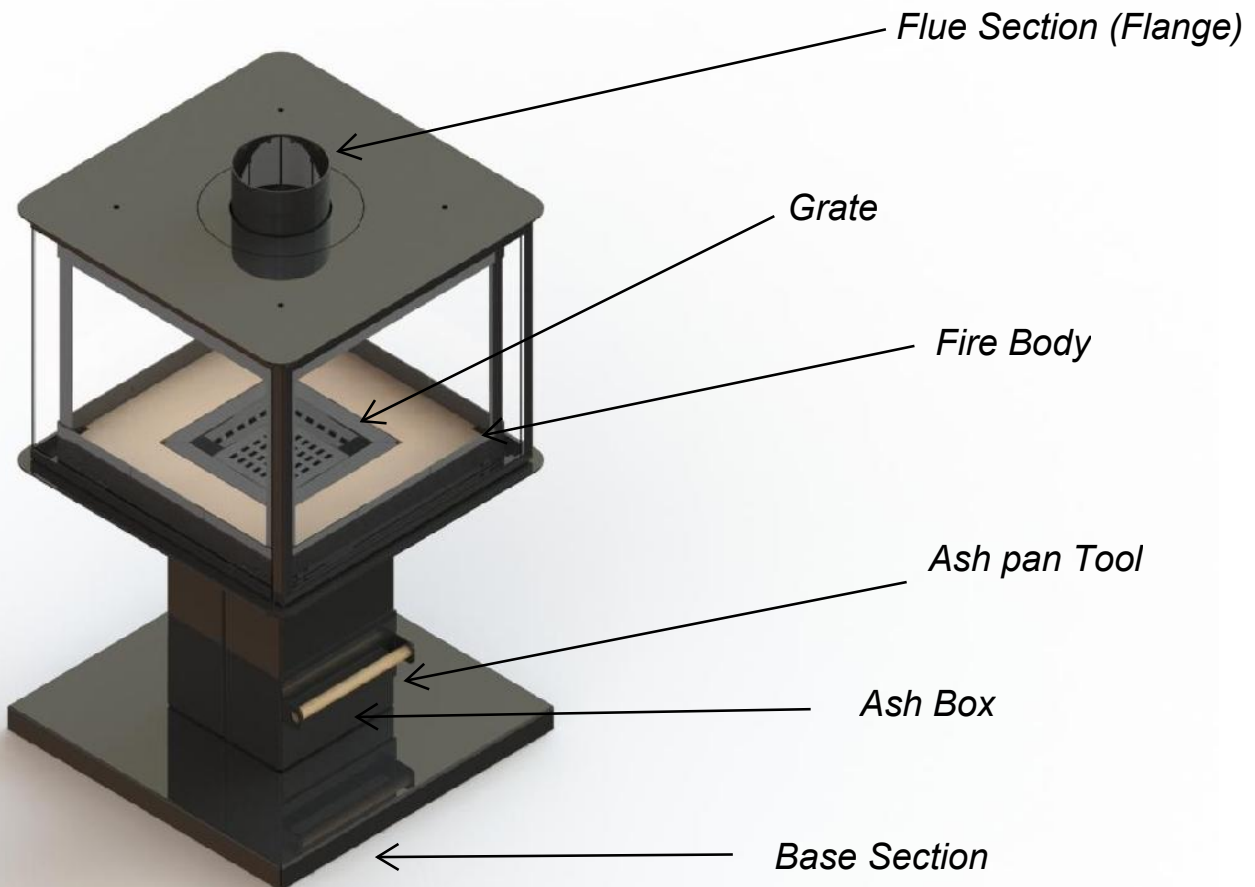

FLANGE POSITIONING

For connecting the flange with the main body follow the steps as in photos below. Remove first the metallic circle of the main body as in (fig.1b). Place easily the connection flange which is packaged inside the fire body (fig.1c). Place the screws than in the side spaces, to fix the flange on the body as in (fig.1d). Finally set the matalic circle on its first position (fig.1e).

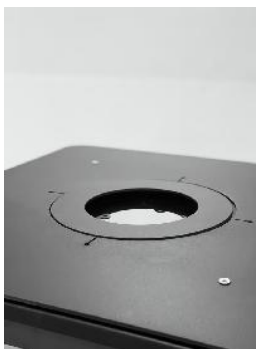

(fig.1a)

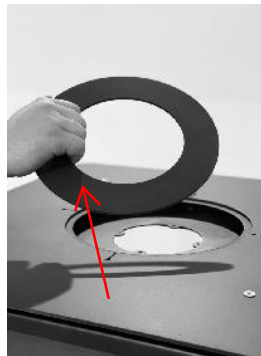

(fig.1b)



(fig.1c)

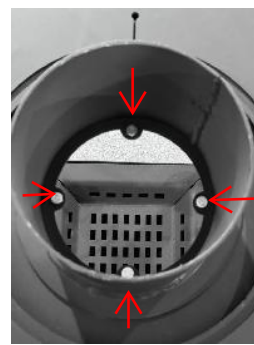

(fig.1d)

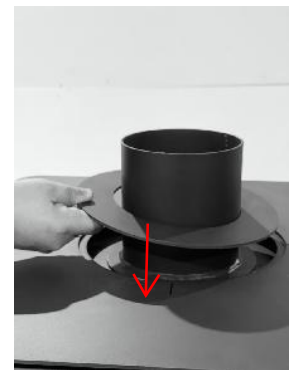

(fig.1e)

FUEL CHOICE

Recommended Fuel

- the manufacturer recommends hardwood billets like beech, hornbeam, oak, alder, birch, ash, etc., with billet or split log dimensions 30cm long and circumferences between 30 and 50cm, and lignite briquettes.
- the humidity of the fuel wood for the appliance should not exceed 20%.

Not Recommended Fuel

You should avoid burning billets of split logs with a humidity of over 20% as it can prevent the appliance from achieving its declared technical specifications, and can reduce the heat output. Burning softwood billets and high-resin wood in the appliance is not recommended, as they result in heavy smoking and frequent cleaning of the appliance and chimney flue.

The following is not allowed to be burned in the heaters: minerals, e.g. coal, tropical wood (like mahogany), chemical products and fluids, (like oil, alcohol, petrol, and naphthalene), laminated boards, or adhesive-bonded, impregnated or pressed wood chips and litter. If any other fuel is allowed, it will be notified on the rating plate.

Avoid filling the hearth with wood fully, optimising the amount of fuel at one-third of the combustion chamber's capacity.

OUTDOOR FIREPLACE STARTUP AND OPERATION GENERAL REMARKS

MATERIAL NEEDED -A few larger wooden billets (split; max. humidity 20%; approx. 10-13 cm)- a handful of splints for kindling (dia. approx. 2-5 cm ; max. humidity 20%,) -Tinder of choice -Matches/Lighter.

Lighting

1. Open Door
2. Stack logs as shown use logs that are no more than 350mm Long.
3. Place kindling on top as shown.
4. Use a tapper or long match to light kindling.
5. Close door once kindling is lit.
6. It will help with lighting if the ash box is opened slightly.
7. Close ash box immediately logs start to burn.

Extinguishing

1. Allow fire to burn itself out.
2. Do NOT use water to extinguish as this is dangerous and may cause glass to shatter causing serious injury or damage to property and damage to the outdoor firelace.

BURNING

This outdoor fireplace is designed to burn wood with a humidity of up to 20%. Using coal, coke, coal-ba-sed products, plastic, litter, cloths and other flammable materials is not allowed. Burning approved wood briquettes made of wood dust or pellet is temporarily allowed, but in small quantities only. The following is practical guidance for assessing the wood used as fuel. The wood which is to have a humidity of 18-20% must be seasoned for 18-24 months or kiln-dried. As the humidity of wood de-creases, its net calorific value rises, which brings financial savings of even up to 30% of the total wood weight needed to run the appliance during one heating season. If the wood used for burning is of too high humidity, then, too much energy needed for evaporation and condensation in the flue pipe or combustion chamber can be consumed, which affects the heating process of a room. Another negative process occurring when the high-humidity wood is used is the emission of creosote, a deposit which damages the chimney flue and, in extreme cases, can result in ignition and a chimney fire. It is therefore recommended to use hardwood like oak, beech, hornbeam or birch. Lower calorific values are typical of the coniferous trees and burning their wood produces heavy soot accumulation on the glass.

NORMAL OUTDOOR FIREPLACE BURNING AND EXTINGUISHING

To prevent flue gases from escaping during the heater's operation, the door should be closed at all times, except for lighting, fuel loading and removing ash. Do not leave the site while lighting the fire when the door is open.

CHIMNEY-FLUE MAINTENANCE

A well-cleaned and maintained chimney provides the basis for correct and safe stove operation. The user must clean the chimney in accordance with the valid regulations. How often you clean and perform the maintenance depends on the chimney insulation and the type of wood used. Using unseasoned wood with a humidity above 20%, or softwood, will pose the risk of a chimney fire related to a thick layer of flammable creosote deposits, which must be removed regularly. Failing to remove the creosote layer inside the chimney liner causes sealing damage, and also contributes to corrosion build-up. Consequently, the regular inspection and maintenance of the stove and its related components are required.

HEARTH CLEANING

Before and after each heating season, the hearth must be cleaned and checked carefully, as leaving ash in the ash drawer over a longer time will cause its chemical corrosion. During operation, regular cleaning of the firebox-combustion chamber must be performed (how often it needs to be done depends on the variety and humidity of the wood used). Use a poker, scrapers, a brush, chimney vacuums and ash separators for cleaning the hearth components.

GRATE MAINTACE AND CLEANING



(fig.2a)



(fig.2b)



(fig.2c)

GLASS CLEANING

The glass gets heated up to high temperatures, so clean it only when the hearth has cooled down. Clean it using approved agents designed for this purpose only (do not use them to clean the firebox parts). Do not use any abrasive agents for this purpose, as this may cause its surface to be scratched.

DOOR OPENING

Door on the outdoor fireplace is easily opened as below. Always use the door accessory and gloves if its nessesary.



3a) Door accessory

ASH REMOVAL

Ash should be removed prior to each time you light the stove. To remove the ash, just empty the ash container located below the fire grate. Regular hearth-ash removal prevents the ash from spilling out. Do not allow ash to spill over the barrier. Remove the ash from the stove when it is cold.

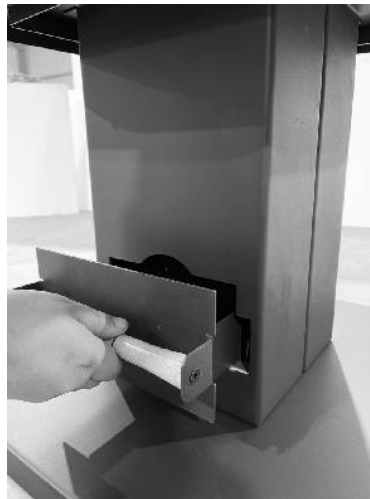

** Remove and clean the ash box each time you light the outdoor fireplace!*

SPARE PARTS

If after many years you find exchanging some parts necessary, contact the supplier or any representative of our company. To order a spare part, submit the information listed in the rating plate located on the back of the guarantee certificate, which must be kept even when the guarantee has terminated.

If you have this information, and our factory documentation, the supplier will be able to deliver all spare parts in a short time.

WARRANTY

A.caminetti warrants brand new outdoor fireplace for 12 months. The warranty covers:

- Production defects.
- Fire-penetration of the steel, assuming that the outdoor fireplace has been fired up correctly.

In case you have questions or require servicing during the warranty period, please contact your dealer who will assist you. Always inform the dealer of which model you have purchased as well as the serial number of your stove.

The following are not covered by the warranty:

- Transportation damages.
- Secondary damages resulting from the use of the product.
- Damages resulting from incorrect use such as superheating. Such damages may be avoided by following the operating manual instructions.
- Glass, soapstone, sandstone and ceramics

If the chips are down and your outdoor fireplace needs repairing under the warranty, you must be able to present a dated and signed invoice stating the name of the dealer and the model. In case of repairs under the warranty, the parts and labor costs will be covered by A.caminetti.

THANK YOU FOR CHOOSING "A.CAMINETTI"!



A.caminetti GmbH

AM Industriegleis 6a, Ergolding / Germany.

info@acaminetti-factory.com

www.acaminetti-factory.com